

## Diesel Generator Set Specifications Sheet

| Generator Specifications  |           |
|---------------------------|-----------|
| Manufacturer              | Turqpower |
| Model                     | TP - P 11 |
| Stand by Power (kVA - kW) | 11 - 9    |
| Prime Power (kVA - kW)    | 10 - 8    |

| Engine Specifications |          |
|-----------------------|----------|
| Manufacturer          | Perkins  |
| Model                 | 403A-11G |
| No. of Cylinders      | 3 - Line |
| Displacement (lt)     | 1,131    |
| Bore & Stroke (mm)    | 77 x 81  |
| RPM                   | 1500     |

| Engine Electrical System  |    |
|---------------------------|----|
| Charg. Alt. Voltage (VDC) | 12 |
| Starter Voltage (VDC)     | 12 |

| Fuel System              |        |
|--------------------------|--------|
| Fuel Tank Capacity (lt)  | 92     |
| Type                     | Diesel |
| Fuel Cons. (lt/h) (%100) | 3,0    |

| Lubricating System        |               |
|---------------------------|---------------|
| Lubricating Capacity (lt) | 4,9           |
| Grade                     | 15W40 API CI4 |
| Change Period (hours)     | 250           |

| Cooling System          |     |
|-------------------------|-----|
| Cooling Capacity (lt)   | 4,9 |
| Max. Ambient Temp. (°C) | 50  |
| Change Period (hours)   | 250 |

| Alternator Specifications |               |
|---------------------------|---------------|
| Voltage (VAC)             | 231 / 400     |
| Frequency (Hz.)           | 50            |
| Type                      | 4 Pole        |
| Cosφ                      | 0,8           |
| Insulation                | H             |
| Protection Class          | IP23          |
| Bearing                   | Single        |
| Coupling                  | Flexible disc |

(1) Emergency Standby Power (ESP): Applicable for supplying power to varying electrical load for the duration of power interruption of a reliable utility source ESP is in accordance with ISO 8528. Overload is not allowed.

(2) Prime Power (PRP): Applicable for supplying power to varying electrical load for unlimited hours. 10% overload capability is available for a period of 1 hour with in 12 hour period of operation

\* ISO 8528: Ratings are given for 25 °C ambient temperature. Altitude: 100 m. above sea level. Derating, please contact us or refer to data sheet. Manufacturer reserves the right to make changes in model, technical specifications, color, equipment and accessories without prior notice.

### Standard scope of supply:

**Engine** with direct injection, water cooled engine, 4 stroke, rated at 1500 RPM, conforming to ISO 3046 / BS 5514 has the following specifications:

- Mechanical governor /Electronic Governor (Optional)
- Turbocharger, pulse tuned exhaust manifold, stainless steel exhaust flexible connection
- Radiator Cooled, turbo charged after cooled
- Plate type, lube oil, cooler
- Filters-fuel, lube oil
- Dry type replaceable paper element air cleaner
- Flywheel housing and flywheel to suit single bearing alternator
- Starting motor – Electric, battery charging alternator
- First fill lube oil and coolant

### Alternator: Flexible disc, Close coupled

- Brushless alternator
- Self-excited, self-regulated
- Class 'H' insulation limited to temperature rise of class H
- Salient pole revolving field
- Single bearing
- Automatic voltage regulator

### Canopy: Modular type, sound isolation cabinet without welding

- Base rail with draw-out type fuel tank is provided with a drain plug, air Vent, inlet and outlet connections, level indicator, manhole etc.
- Sub-base fuel tank with 8 hours capacity at 100% load.
- 12V dry, batteries with connecting leads and terminals
- Custom color application

### Control panel: RAL 9003 White Powder coated control panel manufactured with CRCA sheet , Control Panel is having following features:

- Water and lube oil drain outlets located on the outer surface- Leading to ease of maintenance and cleanliness.
- MCCB of suitable rating with short circuit protection
- Controller which displays voltage, current, KW, PF, Frequency, KWh.
- Indicating lamps for "Load On" and "Set Running"
- Current transformers of suitable ratings
- Copper Cables of suitable capacity with incoming and Outgoing terminations
- Control fuses duly wired and ferruled

## Diesel Generator Set Specifications Sheet

**Controller:** Datakom D300 model

- Alternator voltage: 0 to 300 V-AC (Ph-N)
- Alternator frequency: 0-600 Hz.
- Mains voltage: 0 to 300 V-AC (Ph-N)
- Mains frequency: 0-600 Hz.
- Topology: 1-2-3 phases, with or without neutral
- DC Supply Range: 8.0 to 36.0 V-DC.
- V-A-cos Accuracy: 0.5% + 1 digit
- kW-kVA-kVAr Accuracy: 1.0% + 1 digit
- Current consumption: 500 mA-DC max @ 12V-DC
- Current Inputs: from current transformers. .../5A.
- Digital inputs: input voltage 0 to 36 V-DC.
- Analog input range: 0-5000 ohms.
- Mains and genset contactor outputs: 16Amps@250V
- DC Outputs: Protected mosfet semiconductor outputs, rated 1Amp@28V-DC
- Cranking dropouts: survives 0V for 100ms.
- Magnetic pickup voltage: 0.5 to 50Vpk.
- Magnetic pickup frequency: 0 to 20000 Hz.
- Charge Alternator Excitation: 2W.
- Display Screen: 2.9", 128x64 pixels
- USB Device: USB 2.0 Full speed
- RS-232 Port: selectable baud rate (2400-57600baud)
- Operating temperature: -20°C to 70°C (-4 to +158 °F)
- Storage temperature: -40°C to 80°C (-40 to +176°F)
- Maximum humidity: 95% non-condensing.
- IP Protection: IP65 from front panel, IP30 from the rear (with gasket)
- Dimensions: 172 x 134 x 46mm (WxHxD)
- Panel Cut-out Dimensions: 151 x 111 mm minimum.
- Weight: 300 g (approx.)
- Case Material: High Temperature, non-flammable
- ABS/PC
- Installation: Flat surface mounting on a Type 1 enclosure.
- Rear retaining plastic brackets.

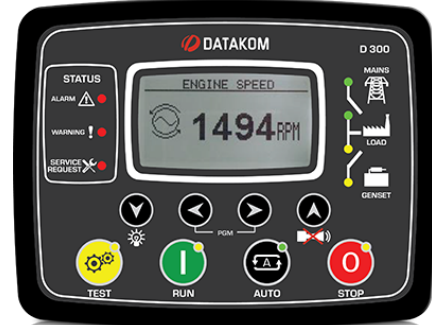

**Optional Items:**

- ATS
- Circuit Breaker
- External type fuel tank
- Synchronous System
- Electronic governor applications
- Earthquake Sensor
- Analog Gauges
- 24 Hours fuel tank
- Speciak frame color
- Special canopy color
- Special type silencer

**Dimensions:**

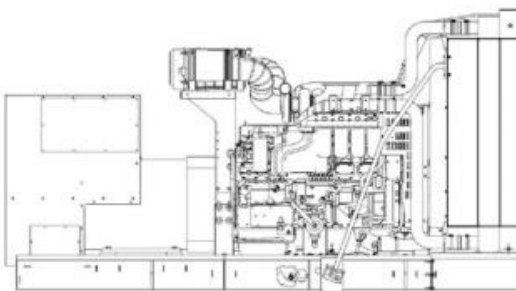

Open Type

| Length (mm) | Width (mm) | Height (mm) | Weight (kg) |
|-------------|------------|-------------|-------------|
| 1400        | 700        | 850         | 270         |

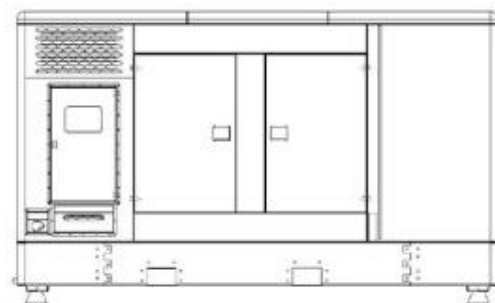

With Canopy

| Length (mm) | Width (mm) | Height (mm) | Weight (kg) |
|-------------|------------|-------------|-------------|
| 1600        | 700        | 1050        | 420         |